



Technical Specs:

Insulator: Black glass filled polyester

PPS-GF30-FR

Flammability: UL 94V-0

Sleeve: Brass

Contact clip(4 finger): Beryllium copper(C17200)

Accepted pin: $\phi 0.40$ to 0.56mm

Forces: (polished steel gauge $\phi 0.43\text{mm}$)

Rated current: 3A

Contact resistance: max $20\text{m}\Omega$

Dielectric resistance: Min 1000V RMS

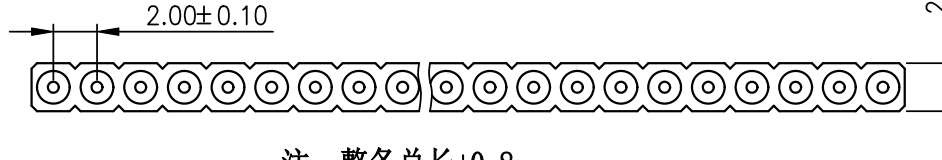

注: 整条总长+0.8

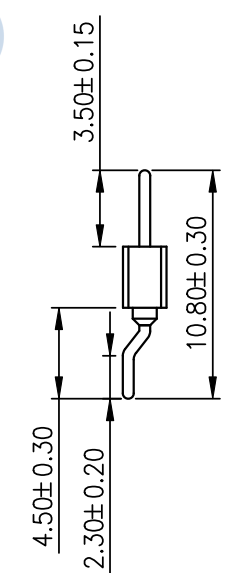
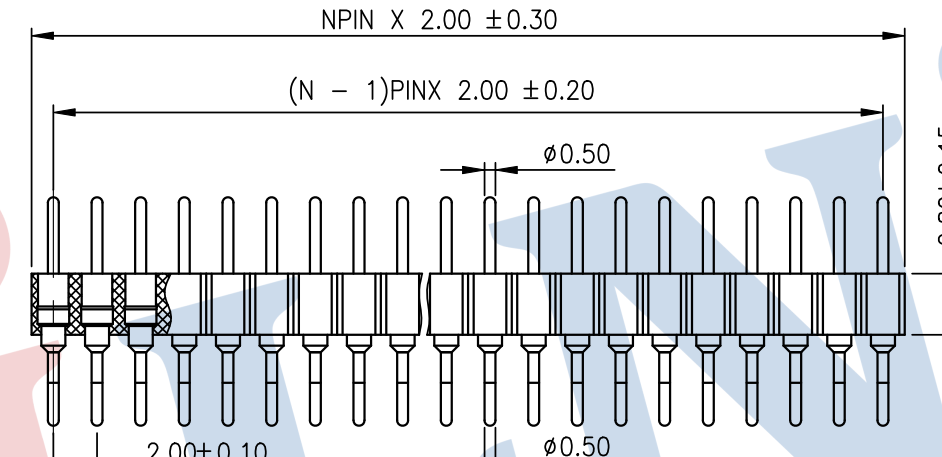

Ordering Information

3612 28 1 XX Z XX 110 X 0 X

No. of Pins
1-40Pin

Contact Plating
SN: Tin
G0: Gold Flash
G2: 2U" Gold
G3: 3U" Gold
G4: 5U" Gold
G5: 10U" Gold
S0: Gold Flash/Tin
Standard: G0

Length
110=11.0mm

Packing
O=PE Bag
A=Tray
T=Tube
R=Reel
M=Reel+Mylar

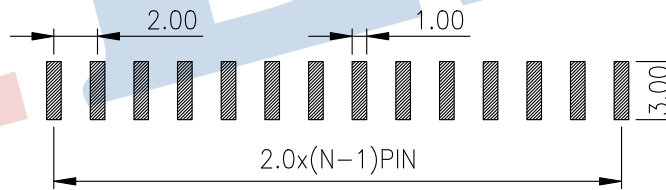

Recommended P.C.B Layout(Top Side)
(PCB BOARD TOLERANCE ± 0.05)

				OPERATION		DRAW	JinChengXin	18.05.11	SCALE	FIT	JILN ® 深圳市锦凌电子有限公司 SHENZHEN JINLING ELECTRONICS CO.,LTD Tel: 86-755-27483253 Fax: 86-755-2997-5588		
				X.X	± 0.30				UNIT	mm			
				X.XX	± 0.20	CHECK		SIZE	A4	PART NO.			3612281XXZXX110X0X
				X.XXX	± 0.10	APPROVE		SHEET	1.5/1	TITLE:			2.0X2.8 双头针单排 卧贴L=11.0
REV	DATE	MODIFICATION DESCRIPTION	CHANGE	DIM	TOL			PROJ.					